

ood

Massage your finger until you see increased color in your fingertip.

Keeping your hand down, press the tip of the lancet firmly against the side of your fingertip. Press the release button.

Gently squeeze from the base of your finger to develop a hanging drop of blood.

rget

Find the target area on the test strip.

To prevent error messages, the meter must be on a table free of vibrations.

6. Apply the Blood

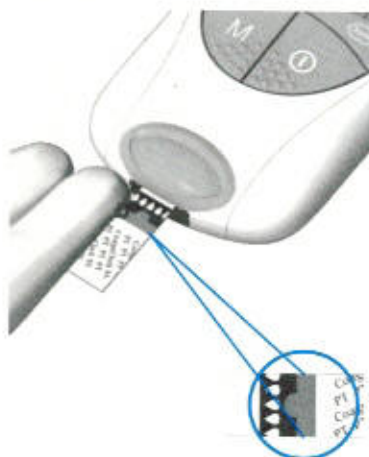

Within 15 seconds of sticking your fingertip, apply the blood to the target area of the test strip—from the side of the test strip.

■ *Hold the blood drop to the test strip until you hear a beep. The flashing blood drop symbol disappears.*

Do not add more blood to the test strip. Do not touch the test strip.

■ *The result appears in about 1 minute.*